



**DIAMOND  
WALL**  
INSULATING STUCCO SYSTEM



## THE PROVEN SOLUTION TO MEET ENERGY CODE AND CONTINUOUS INSULATION (CI) REQUIREMENTS

- ◆ Improved energy efficiency
- ◆ Timeless beauty of stucco
- ◆ High impact resistance with minimal maintenance
- ◆ Shorter construction schedule
- ◆ LEED and CA Title 24 capable

Diamond Wall Insulating Stucco System is a cost-effective option for architects and builders looking to optimize the energy performance of a structure. Diamond Wall incorporates rigid foam board as part of the system, which creates a layer of continuous insulation (CI). CI is one of the most effective means of improving energy efficiency because it reduces thermal bridging across the framing and air leakage through the wall.

Diamond Wall is the code compliant wall system solution utilizing foam board sheathing for residential and commercial applications. It has the appearance and advantages of traditional three-coat stucco that the market desires, but with increased energy efficiency and schedule savings. It accomplishes this without compromising the one-hour fire-resistive-rated assemblies designers rely on.

Diamond Wall is a proprietary formulation, expressly engineered by Omega to meet the increased energy code demands many local jurisdictions are adopting. It is an economical way to comply with CI needs and stringent requirements such as CA Title 24 Building Energy Efficiency Standards.



PRIVATELY OWNED  
AMERICAN MADE



## Diamond Wall Insulating Stucco Solution

Diamond Wall is the leader in the one-coat stucco wall systems market. For over forty years, it has been extensively tested with millions of square yards successfully installed. The following components comprise the Diamond Wall Insulating Stucco Systems:

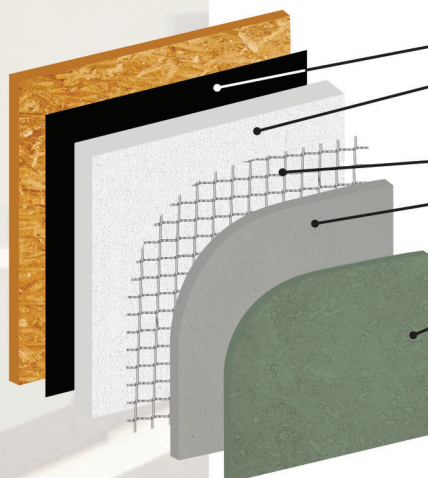

- Weather Barrier:** Grade D paper or other approved barriers
- Rigid Insulation Board:** EPS, XPS, or polyisocyanurate board with a thickness of 1 to 1.5 inches over open framing or .5 to 1.5 inches over sheathing
- Lath:** Woven, welded, or metal lath
- Base Coat:** Diamond Wall Concentrate is a factory prepared blend of portland cement, chopped fibers and proprietary ingredients complying with ASTM C150; It is field mixed with sand, water and an optional admix <sup>(1)</sup>
- Finish:** A variety of finish options are available, including: Omega ColorTek stucco, Omega OmegaFlex/AkroFlex acrylic-based finishes, and the Omega Masonry Adhered Veneer Systems (MAVS)

<sup>1</sup> Factory blended sanded base coat is also available

### DIAMOND WALL INSULATING STUCCO SYSTEMS ADVANTAGES:

FEATURES	BENEFITS
Improved energy efficiency	Using foam board increases the wall assembly's U-factor
Reduced labor costs	Only requires one base coat application
Shorter construction schedule	Finish coat can be applied in as little as 24-hours after the brown coat. Some finishes may require longer cure times
Consistency	Factory blended mix requiring only sand, water, optional admix to be added in the field
Lower Weight	Reduces the exterior cladding weight by approximately 50% compared to three coat stucco
Low life-cycle costs	Will last decades with little maintenance
Durable and impact resistant	Can withstand years of weather and physical abuse
Cement-based	Fungus, rot, and insect resistant
Fire-resistant	Non-combustible and available in 1-hour rated fire-resistant assemblies
Acceptable base coat for a variety of finishes	Stucco, acrylic finish, paint, and stone
System Warranty	Up to 18 year system warranty when used in combination with other Omega products

Diamond Wall is an economical way to support complying with the prescriptive and performance options set forth by the 2019 California Title 24 Energy Efficiency Standards. Diamond Wall has been used to meet or exceed energy building codes for over 40 years. For additional information on how Diamond Wall can help comply with energy building codes, visit [omega-products.com/green](http://omega-products.com/green) or scan here:



Diamond Wall is available as a concentrate (DWC) that is field mixed with sand or factory pre-sanded. It may be ordered in 80 lbs bags, 3000 lbs super sacks, or mini-silos (in select markets).

